

The historic monuments : symbol of historic events having certain cultural significance in past.

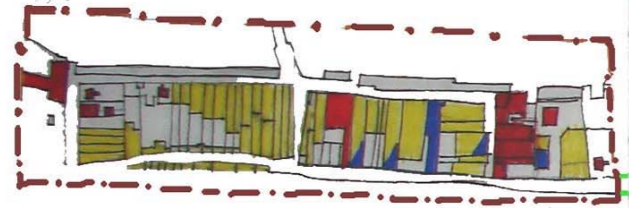

URBAN CONSERVATION
The real value of any Heritage city comprise of four essential factors:

- 1) Physical (the built form)
- 2) Socio - economic
- 3) Political
- 4) Religious

Present area of study :
The sacred Cauvery edge of Kumbakonam

Elements of Kumbakonam :

- Temples
- Mattams and Chatrams , Padfitores.
- Colonial buildings.
- Old and new residential structures
- Old buildings in dilapidated state
- Other religious buildings
- New commercial buildings

OPPORTUNITIES

The presence of these historic monuments and religious structures along the river edge and being used for some religious activities in the present context provides the opportunity of strengthening the hidden network between them, thereby improving the conditions around them and weaving the spirit of those places (which is under the threat of getting vanished) with the entire system of KUMBAKONAM

STRATEGIES

Identifying the nodes and strengthening the node itself so as to strengthen the network within them.

Assigning appropriate usage to the sacred monuments and places and designing its surroundings so as to have their importance maintained and there by allowing new development happen.

Weaving the network of the system of KUMBAKONAM

ISSUES

The sacred edge of the river Cauvery is poorly maintained and is getting misused because of :

- Imposition of new economic forces**
- Decrease in water level in Cauvery.**
- Need for improved living conditions.**

The religious structures of historic importance are losing their value because of :

- Change in usage**
- Encroachment**
- Inaccessible conditions**
- Surrounding land use**

